

## EMERGENCY

### DYNAMO 2W LED NON MAINTAINED DOWNLIGHT

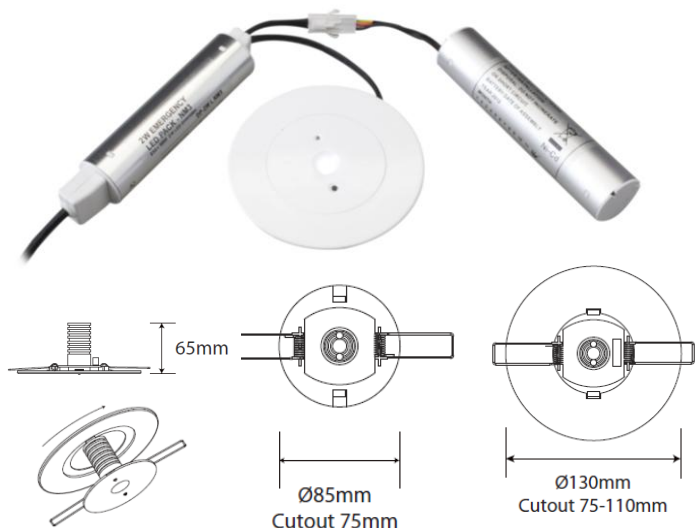

|   |                     |
|---|---------------------|
| <b>Code:</b>  | <b>R2WLEDNME-01</b> |
| <b>Light output in emergency L<sub>100</sub> (lm):</b>      | 190                 |
| <b>Illuminance @ 1m (lx):</b>                               | 25                  |
| <b>Beam Angle (deg):</b>                                    | 120                 |
| <b>Colour Temp L<sub>100</sub> (k):</b>                     | 7,000               |
| <b>CRI L<sub>100</sub> (Ra):</b>                            | 75                  |
| <b>Charge Power Consumption (W):</b>                        | <2                  |
| <b>Average LED Life L<sub>70</sub>F<sub>10</sub> (hrs):</b> | 30,000              |
| <b>Operating Ambient Temperature (°C):</b>                  | 0<Ta<+40            |
| <b>Ingress Protection (IP):</b>                             | IP20                |
| <b>Diameter (mm):</b>                                       | 85/130              |
| <b>Depth (mm):</b>  | 65                  |
| <b>Cut out (mm):</b>  | 75 - 110            |
| <b>Min Order Qty/Carton Qty:</b>                            | 1/12                |
| <b>Weight (Kg):</b>   | 0.71                |
| <b>Guarantee (Yrs):</b>                                     | 2                   |

It is a legal requirement to provide adequate emergency lighting in our buildings. This recessed, compact, discrete and attractive fitting utilising the latest energy efficient LED technology comes complete with battery pack and provides a high lumen output. It is an alternative to the bulky emergency packs usually associated with backup lighting and can be used to provide a common emergency solution throughout the whole building. This fitting provides an ideal solution where emergency versions of standard fittings are not available. It has a standard and additional trim which extends its functionality for retro-fit where larger holes are already cut. Ideal for installation in:

- Offices
- Public buildings
- Shops and stores
- Health Centres
- Hospitals
- Schools
- Hotel rooms
- Pubs, Clubs & Restaurants

| FEATURES  | BENEFITS   |
|---|--|
| <ul style="list-style-type: none"> <li>Complete kit pre-wired with plug &amp; play connectors comprising:                             <ul style="list-style-type: none"> <li>LED downlight</li> <li>Controller &amp; driver pack</li> <li>Battery pack</li> </ul> </li> </ul> | <ul style="list-style-type: none"> <li>Nothing else required                             <ul style="list-style-type: none"> <li>1<sup>st</sup> fix mains connection ensures LED head is not damaged during building works</li> <li>Fast and simple installation with plug &amp; play connectivity</li> <li>Pokey Yokey connectors ensure correct polarity connections</li> </ul> </li> </ul> |
| <ul style="list-style-type: none"> <li>Compact design</li> <li>Complete with extension bezel</li> </ul>   | <ul style="list-style-type: none"> <li>Provides a discrete emergency solution up to 75mm cut-out</li> <li>Covers existing hole cut-outs up to 110mm diameter for retro-fit requirements or poor/ragged holes cut-outs</li> </ul>   |
| <ul style="list-style-type: none"> <li>Utilises an MLS single 2W, high flux, 190 lumen LED chip package</li> </ul>  | <ul style="list-style-type: none"> <li>Provides long life up to 30,000 hours</li> <li>High lumen output provides excellent emergency light coverage</li> <li>Low energy consumption requires smaller batteries</li> <li>Lighter weight makes product easier to install</li> </ul>  |
| <ul style="list-style-type: none"> <li>Die cast aluminium heat sink for excellent thermal management ensures LED junction temperature remains within recommended limits</li> </ul>  | <ul style="list-style-type: none"> <li>Ensures LED life is not prematurely shortened due to heat</li> <li>Low maintenance costs with no lamp changes required</li> </ul>   |
| <ul style="list-style-type: none"> <li>C/w 3.6v/3Ah NiCAD rechargeable battery pack</li> <li>Non-maintained operation</li> </ul>  | <ul style="list-style-type: none"> <li>Provides 3 hour emergency operation when the mains power supply is lost</li> </ul>  |
| <ul style="list-style-type: none"> <li>Manual test button</li> <li>LED status indicator</li> </ul>  | <ul style="list-style-type: none"> <li>Allows functional LED and battery condition test</li> <li>Provides visual indication that there is a permanent live supply and that the system is in charge mode</li> </ul>   |
| <ul style="list-style-type: none"> <li>120 degree beam</li> </ul>   | <ul style="list-style-type: none"> <li>Enhances uniform light coverage for emergency operation</li> </ul>  |
| <ul style="list-style-type: none"> <li>White finish trim</li> </ul>   | <ul style="list-style-type: none"> <li>Attractive aesthetics and suitable for most installations</li> </ul>  |

PLEASE NOTE – INFORMATION CONTAINED IN THIS DOCUMENT IS SUBJECT TO CHANGE WITHOUT PRIOR NOTICE