

VEGA 14W IP65 BULKHEAD, 4000K, PLAIN DIFFUSER, MICROWAVE SENSOR, EMERGENCY, GREY & BLACK

RVE01440DME-01, RVE01440DME-04, RVE01440DME-24

PLEASE READ INSTRUCTION BEFORE COMMENCING INSTALLATION AND RETAIN FOR FUTURE REFERENCES.
! Electrical products can cause death or injury, or damage to property. If in any doubt about the installation or use of this product, consult a competent electrician

Note:

Product technical information and specification may change over time without prior notification. For the latest technical information please visit our web site www.ledgrouprobust.com or www.ledgrouprobust.com.au or ideal.co.nz

Specifications

Model No:	RVE01440DME
Supply Voltage:	220/240V 50Hz
Power Consumption:	14W
Lumen Output:	1050lm
CCT:	4000K
CRI:	85
Beam Angle:	110°
Power Factor:	0.7
Ta Range:	-20°C ~ 35°C
IP Rating:	65
Safety Class:	Class II
Detection range:	360 detection angle, 1-8m motion 2.8m mounting height
Time Delay:	Adjustable time delay 8 second ~ 12 minutes
Light Level Adjustment:	Daylight to night adjustable
Battery	6V x 1Ah Ni-Cd
Battery Life	Greater than 4 years normal use
Diameter:	300mm
Depth:	91mm
Weight:	1.35kg
Warranty:	3 Years

Suitable for mounting on a normally flammable surface
This fitting is not suitable for installation where ambient air temperature is above 35°C
Complies with EN60598-1:2008+A11:2009, EN62493:2010,
EN61547:2009, EN61000-3-3:2008, EN60669-1:1999+A2:2008
EN61000-3-2:2006+A1:2009+A2:2009, AS/NZS 2293.3
EN5515:2006+A1:2007+A2:2009,





Switch testing

The green led should come on indicating correct battery charge status, all LEDs will come on. When supply to the switched live PL is lost, battery will operate fitting in emergency mode. Interrupt supply by pressing the test switch, the fitting will then operate in emergency mode for a short period of time.

Installation

1. Ensure mains supply is switched off before commencing work
2. Ensure there is at least 100mm of free space around the luminaire location
3. Remove diffuser and LED plate from base of the fitting
4. Drill cable entry and mounting holes in the base
5. Mark appropriate fixing hole positions on wall, check location of buried cables, pipes and other building services before drilling.
6. Feed supply cables to cable entry hole and attach base to surface
7. Write installation date on battery and connect battery
8. Connect wires from unswitched supply to terminals on plate, brown to PL and Blue to N; For fitting always on , link terminal "SL" to terminal "PL", fitting controlled by switch connect switched live wire to terminal SL and permanent live to PL.
Note: if "SL" terminal not connected, fitting works as non-maintained
9. Attached LED plate to the base: align the centre point of the unlock & lock indicator on the tray with the location mark on the base, rotate clockwise so that it is secure
10. Refit trim/ diffuser to base. (note: ensure that trim and base are aligned)

Sensor symbol

-  Optimal mounting height of 2.5m. Turn the dial fully anticlockwise to select minimum range (approx. 1m) and fully clockwise to select maximum range (approx. 8m).
-  The light can be set to stay ON for any period of time between approx. 8sec (turn fully anticlockwise) and a maximum of 12min (turn fully clockwise). Any movement detected before this time elapse will re-start the timer. It is recommended to select the shortest time for adjusting the detection range and for performing the walk test.
-  Lux levels can be selected anywhere from 2-2000lux.
-  Turn the dial fully anticlockwise to select dusk- to-dawn operation at about 10lux. Turn it fully clockwise to select daylight operation at about 2000lux. The dial must be turned fully clockwise when adjusting the detection zone and performing the walk test in daylight.

Information for the Product user:

1. Please note the requirement to dispose of Waste Electrical & Electronic Equipment separately from household waste (WEEE marked with crossed out wheellie bin symbol).
2. Please consider your role in contributing to re-use and recycling by returning this product at end of life to a collection centre for waste electrical equipment or a Civic Amenity site, or to a retail outlet from which you are purchasing a replacement.
3. This equipment may contain substances that are hazardous to health and the environment if disposed of carelessly. It is important that it is separated from normal household waste and recycled in the WEEE chain
4. The "crossed out wheellie bin symbol" on a product indicates this equipment must not be disposed of in normal household waste, but should be disposed of according to local WEEE regulations

The Installation must be carried out by an electrician

LED Group

Western Retail Park
Nangor Road
Dublin 12
Ireland
Issue 1 250515

Tel: +353 1 7099000
Fax: +353 1 7099060
Email: info@led.ie
Website: www.led.ie



Testing

The emergency lighting must be inspected and tested regularly in accordance with local codes of practice: note: for safety reasons tests should be carried out during daylight hours.

The minimum recommended test schedule is as follows:

After installation, allow 24 hours to ensure full battery charge and then interrupt the supply; the maximum duration time is 3 hours check that LEDs are still lighting. (NZ: 16 hour charge time, maximum duration time 2 hours)

1. Daily check that charge indicator LED is working
2. Monthly, interrupt mains for a short period and check LED lights
3. Annual 12 month check, full duration test. Interrupt mains supply, LEDs will light and should last for a minimum 3 hours operation: batteries must be replaced when they can no longer support 3 hour operation.
4. Complete record sheet on installation and retain in maintenance file.
5. Update file with ongoing test records for inspection by fire officer or other duly authorised person

Installation and Maintenance Record:

Installer

Installation

Type

Installation test duration & Date

Month	Test	1 st Year		2 st Year		3 st Year		4 st Year		5 st Year	
		Signed	Date	Signed	Date	Signed	Date	Signed	Date	Signed	Date
1	Short										
2	Short										
3	Short										
4	Short										
5	Short										
6	Short										
7	Short										
8	Short										
9	Short										
10	Short										
11	Short										
12	Short										
	3Hr.										

The Installation must be carried out by an electrician

LED Group ROBUS Australia
 9/210 Queensport Road North
 Murarrie
 QLD 4172
 Australia

Tel: +61 73893 1488
 Fax: +61 73112 1927
 Email: purchases@ledgrouprobust.com.au
 Website: www.ledgrouprobust.com.au

LED Group Robus [New Zealand Office]
 4 Henderson Place, Penrose
 Po Box 13642
 Onehunga, Auckland
 New Zealand

www.ideal.co.nz
www.ledgrouprobust.com

Installation diagram

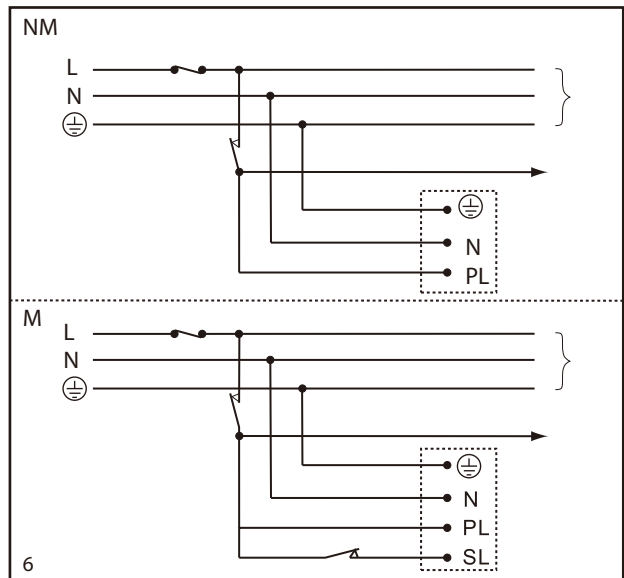
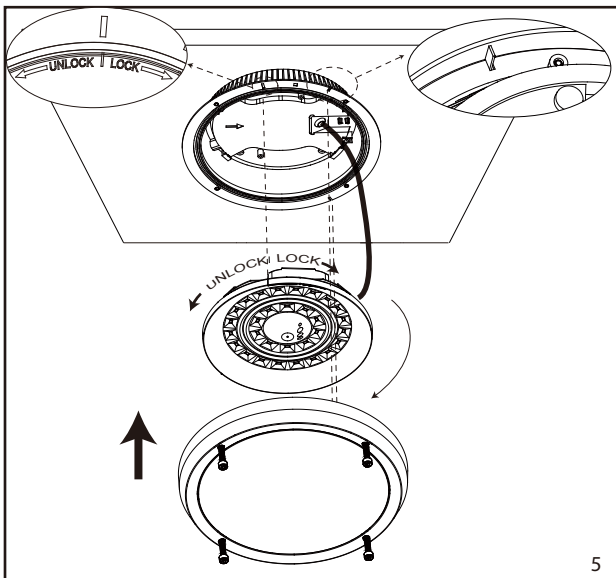
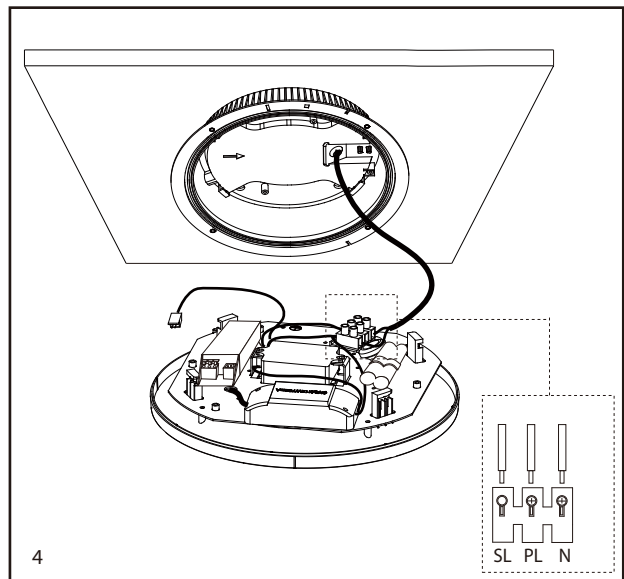
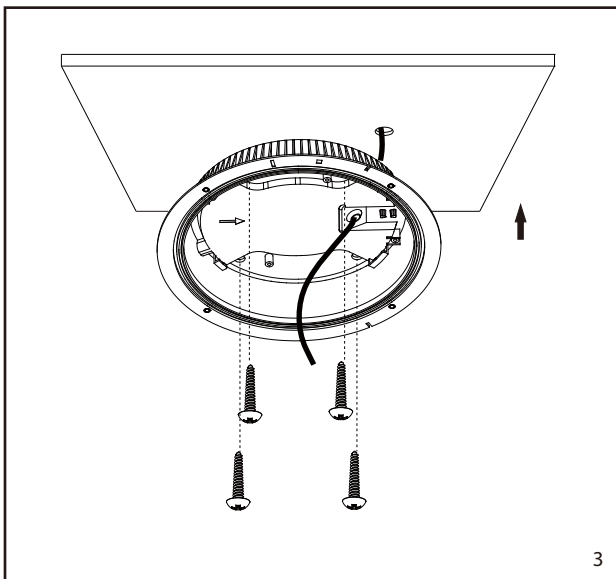
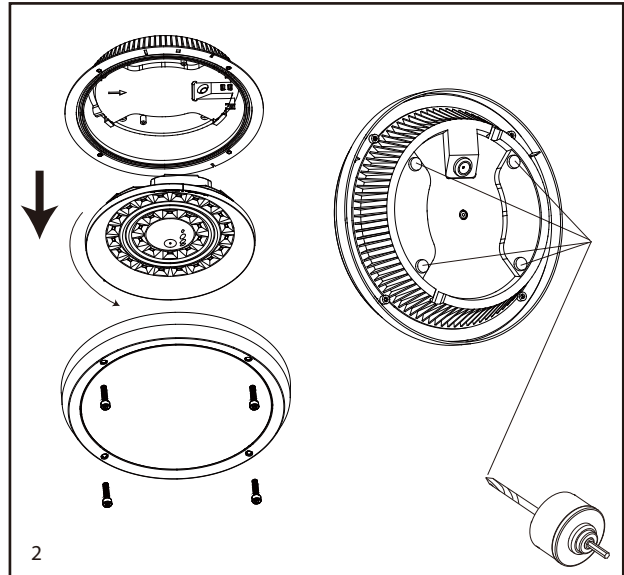
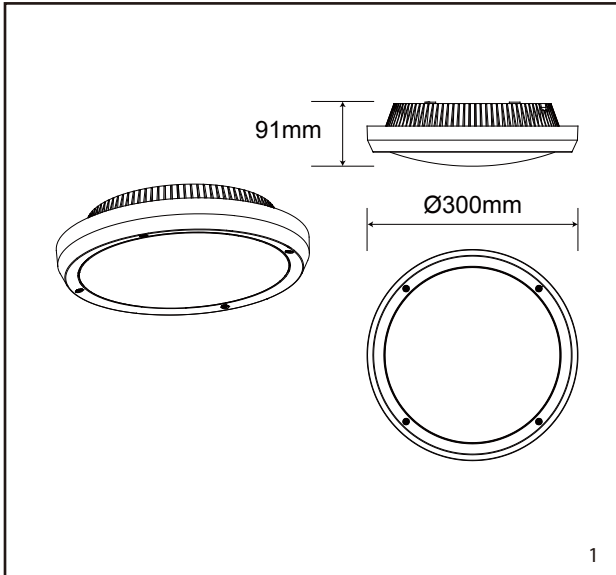

The Installation must be carried out by an electrician

LED Group
Western Retail Park
Nangor Road
Dublin 12
Ireland

Tel: +353 1 7099000
Fax: +353 1 7099060
Email: info@led.ie
Website: www.led.ie

